

# Whirlpool

*June Block of the Month – Beyond Beginner - 12 ½ inches*

**Cutting:** Red, White and Blue

Red: Four 3 ½ x 6 ½ inch rectangles.

White: Eight 3 ½ squares, Four 3 7/8 inch squares cut in half diagonally to make eight triangles.

Red: One 7 ¼ inch square cut in half diagonally both directions to make four triangles.

**Sewing:**

We are going to make a chevron unit using the Red rectangles and White squares. Draw a diagonal line on the reverse side of White squares. Place right sides together on end of Red rectangle and sew just to the right of the line. Fold triangle over to check placement, then trim ¼ inch from seam. Press toward White triangle. Flip the rectangle over and repeat on the other side to complete four of these units.

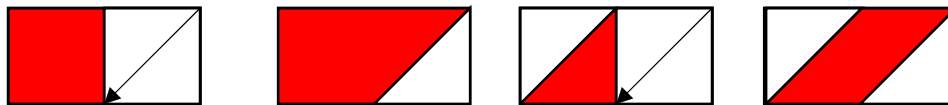

The other unit in this block is Flying Geese. Make four of these using the four large Blue Triangles and eight small triangles:

Sew small triangle to large triangle, lining up point. Sew with a ¼ inch seam

Press seam toward White triangle.

Sew a second White triangle to the opposite side of background triangle with a ¼ inch seam.

Press seam toward White triangle. Trim off dog ears.

Sew Chevron units to the top of Flying Geese units. Sew together as illustrated to complete block.

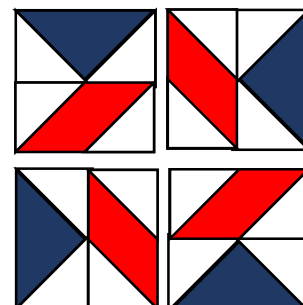
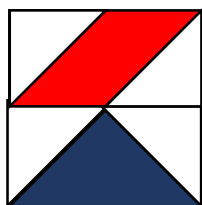
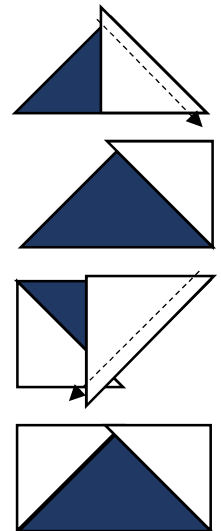

Coos Sand 'N Sea Quilt Guild 2018-2019